

WEST SUSSEX COUNTY COUNCIL
((HORSHAM DISTRICT) (PARKING PLACES AND TRAFFIC REGULATION)
(CONSOLIDATION No.2) ORDER 2006)
(AMENDMENT No.2) ORDER 2008

HORSHAM & HORSHAM NORTH: LOCATION OF WAITING RESTRICTIONS

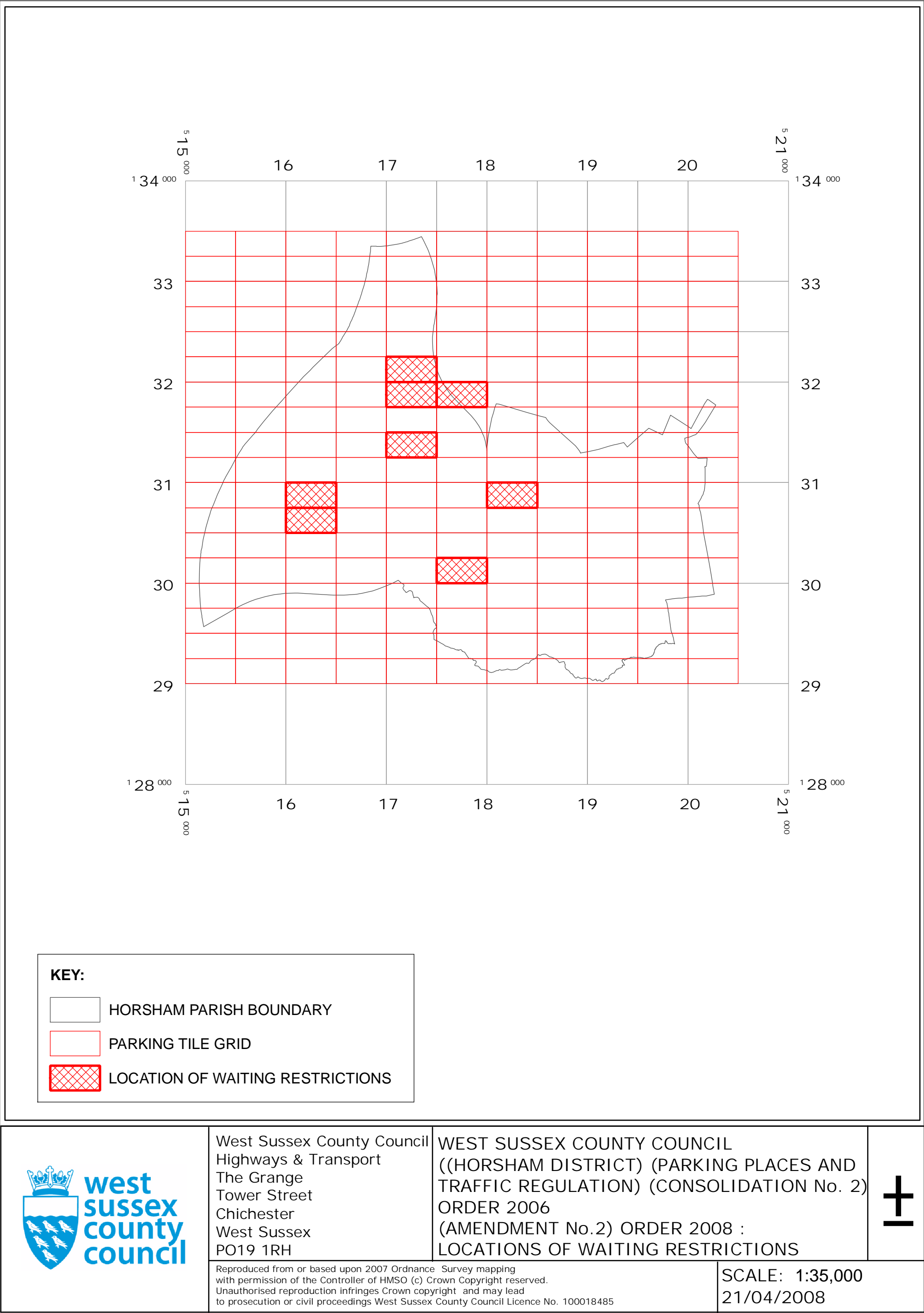

~~WEST SUSSEX COUNTY COUNCIL~~
~~((HORSHAM DISTRICT)) (PARKING PLACES AND TRAFFIC REGULATION)~~
~~(CONSOLIDATION NO. 2) ORDER 2006)~~
~~(AMENDMENT NO. 2) ORDER 2008~~

West Sussex County Council in exercise of their powers under Sections 1 (1) 2 (1) and (2), 4 (2), 45, 46, 49 and 53 and Part IV of Schedule 9 of the Road Traffic Regulation Act 1984 "the Act" as amended and of all other enabling powers and after consultation with the chief officer of police in accordance with Part III of Schedule 9 to the Act hereby make the following Order:-

1. This Order shall come into operation on the twenty first day of April 2008 and may be cited as "West Sussex County Council ((Horsham District) (Parking Places and Traffic Regulation) (Consolidation No. 2) Order 2006) (Amendment No. 2) Order 2008."
2. The "West Sussex County Council (Horsham District) (Parking Places and Traffic Regulation) (Consolidation No.2) Order 2006" is hereby amended by the deletion from it of the plans specified in the First Schedule to this Order and the substitution of the plans attached in the Second Schedule to this Order.

FIRST SCHEDULE
Plan numbers to be revoked

TQ1630NWN (Issue No. 2)
TQ1630NWS (Issue No. 2)
TQ1731NEN (Issue No. 2)
TQ1730SES (Issue No. 3)
TQ1732SWS (Issue No. 2)
TQ1731NWN (Issue No. 3)
TQ1731SWN (Issue No. 3)
TQ1830NWN (Issue No. 3)

SECOND SCHEDULE
Plans to be substituted
(as attached)

TQ1630NWN (Issue No. 3)
TQ1630NWS (Issue No. 3)
TQ1731NEN (Issue No. 3)
TQ1730SES (Issue No. 4)
TQ1732SWS (Issue No. 3)
TQ1731NWN (Issue No. 4)
TQ1731SWN (Issue No. 4)
TQ1830NWN (Issue No. 4)

The COMMON SEAL of WEST SUSSEX
COUNTY COUNCIL was hereto affixed

the ~~FIFTEENTH~~ day of APRIL 2008
in the presence of

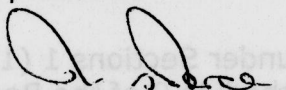

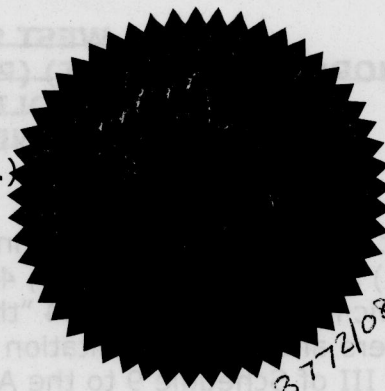
Authorised Signatory

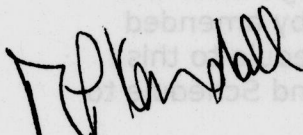

09/02 DELEGATED AUTHORITY

I HEREBY CERTIFY THIS TO BE
A TRUE COPY OF THE
ORIGINAL DOCUMENT

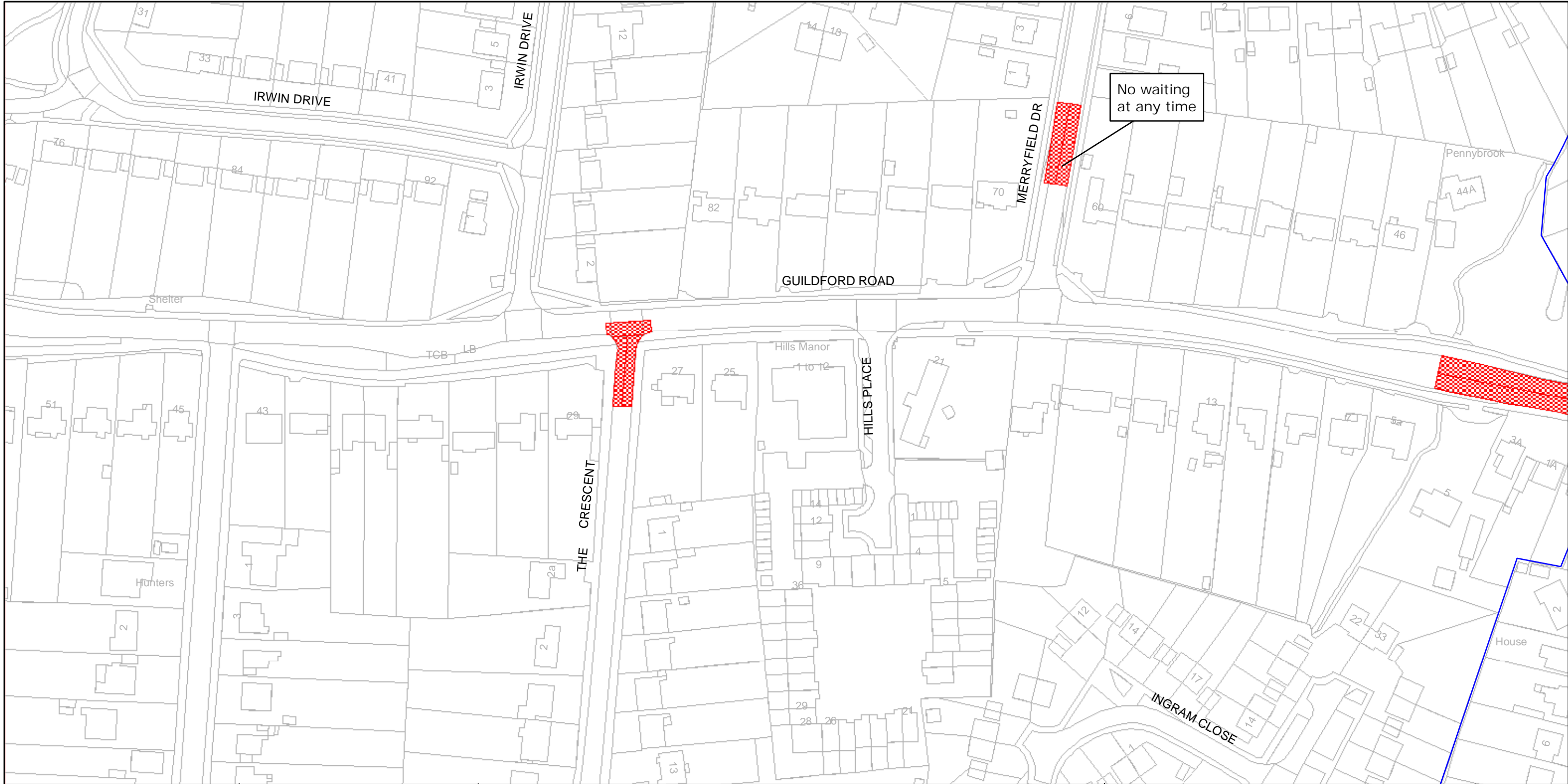
COUNTY SECRETARY



West Sussex County Council
 Highways & Transport
 The Grange
 Tower Street
 Chichester
 West Sussex
 PO19 1RH

HORSHAM DISTRICT: HORSHAM
 WAITING RESTRICTIONS

Reproduced from or based upon 2007 Ordnance Survey mapping with permission of the Controller of HMSO (c) Crown Copyright reserved.
 Unauthorised reproduction infringes Crown copyright and may lead to prosecution or civil proceedings West Sussex County Council Licence No. 100018485

TILE REF NO:
 TQ1630NWN

SHEET NO 4
 SHEET ACTIVE FROM - 21/04/2008



SCALE:
 1:1250



West Sussex County Council
Highways & Transport
The Grange
Tower Street
Chichester
West Sussex
PO19 1RH

HORSHAM DISTRICT: HORSHAM
WAITING RESTRICTIONS

Reproduced from or based upon 2007 Ordnance Survey mapping with permission of the Controller of HMSO (c) Crown Copyright reserved.
Unauthorised reproduction infringes Crown copyright and may lead to prosecution or civil proceedings West Sussex County Council Licence No. 100018485

TILE REF NO:
TQ1630NWS

SHEET NO 3

SHEET ACTIVE FROM - 21/04/2008



SCALE:
1:1250

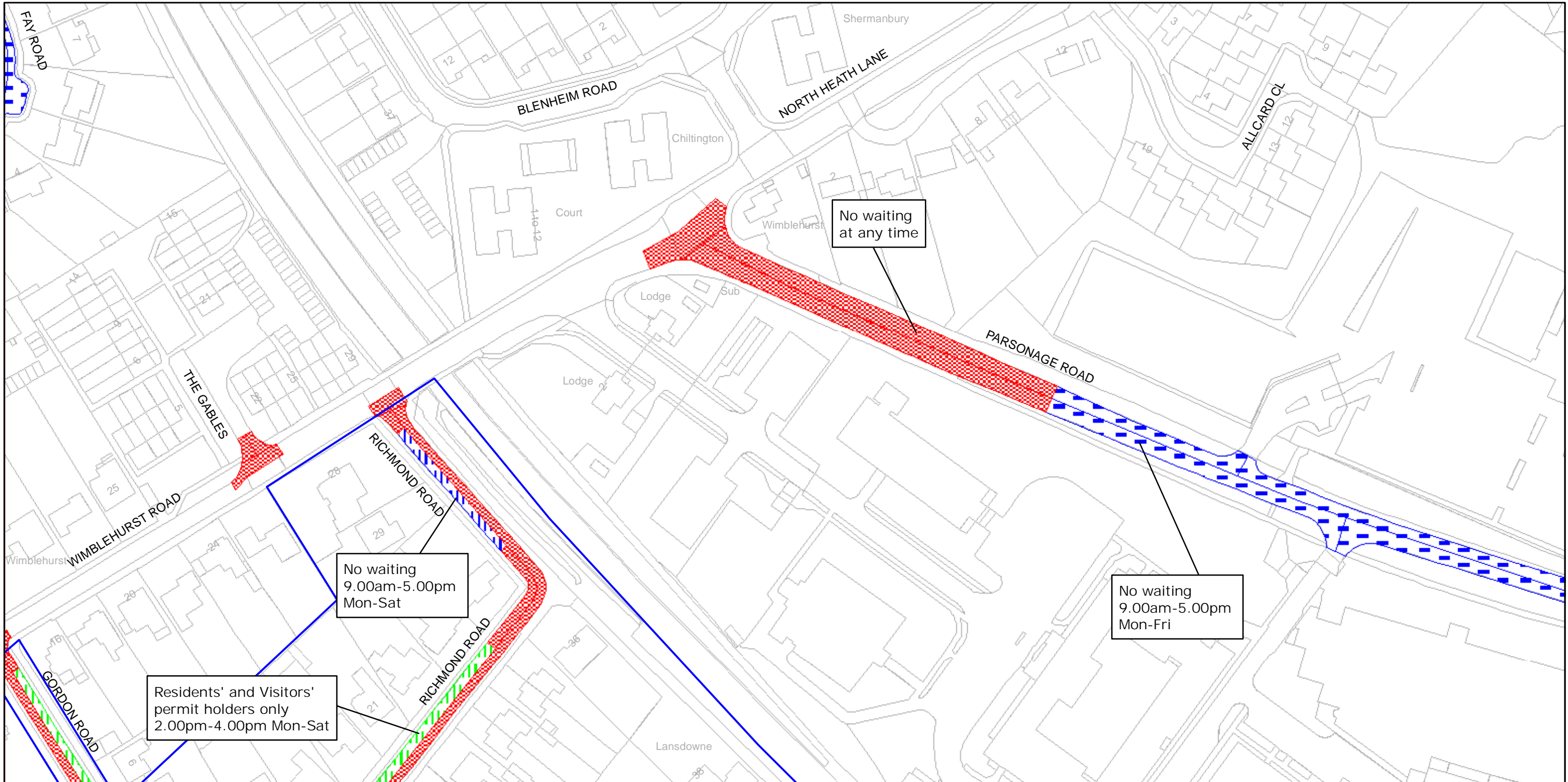

West Sussex County Council
Highways & Transport
The Grange
Tower Street
Chichester
West Sussex
PO19 1RH

HORSHAM DISTRICT: HORSHAM AND NORTH HORSHAM

WAITING RESTRICTIONS

Reproduced from or based upon 2007 Ordnance Survey mapping with permission of the Controller of HMSO (c) Crown Copyright reserved.
Unauthorised reproduction infringes Crown copyright and may lead to prosecution or civil proceedings West Sussex County Council Licence No. 100018485

TILE REF NO:
TQ1731NEN

SHEET NO 3

SHEET ACTIVE FROM - 21/04/2008



SCALE:
1:1250

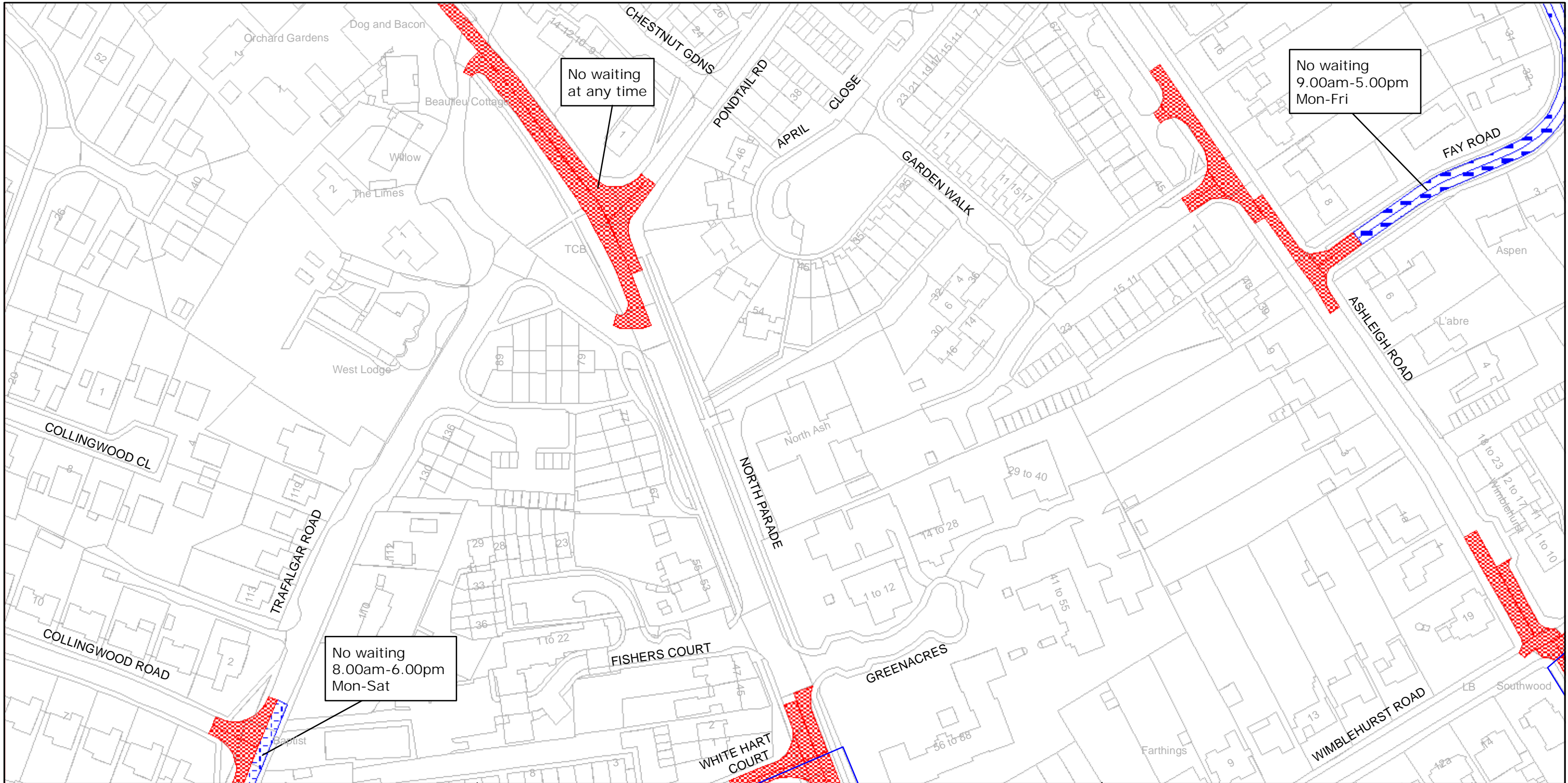

West Sussex County Council
Highways & Transport
The Grange
Tower Street
Chichester
West Sussex
PO19 1RH

Reproduced from or based upon 2007 Ordnance Survey mapping with permission of the Controller of HMSO (c) Crown Copyright reserved.
Unauthorised reproduction infringes Crown copyright and may lead to prosecution or civil proceedings West Sussex County Council Licence No. 100018485

HORSHAM DISTRICT: HORSHAM

WAITING RESTRICTIONS

TILE REF NO:
TQ1731NWN

SHEET NO 4
SHEET ACTIVE FROM - 21/04/2008

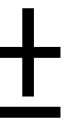

SCALE:
1:1250

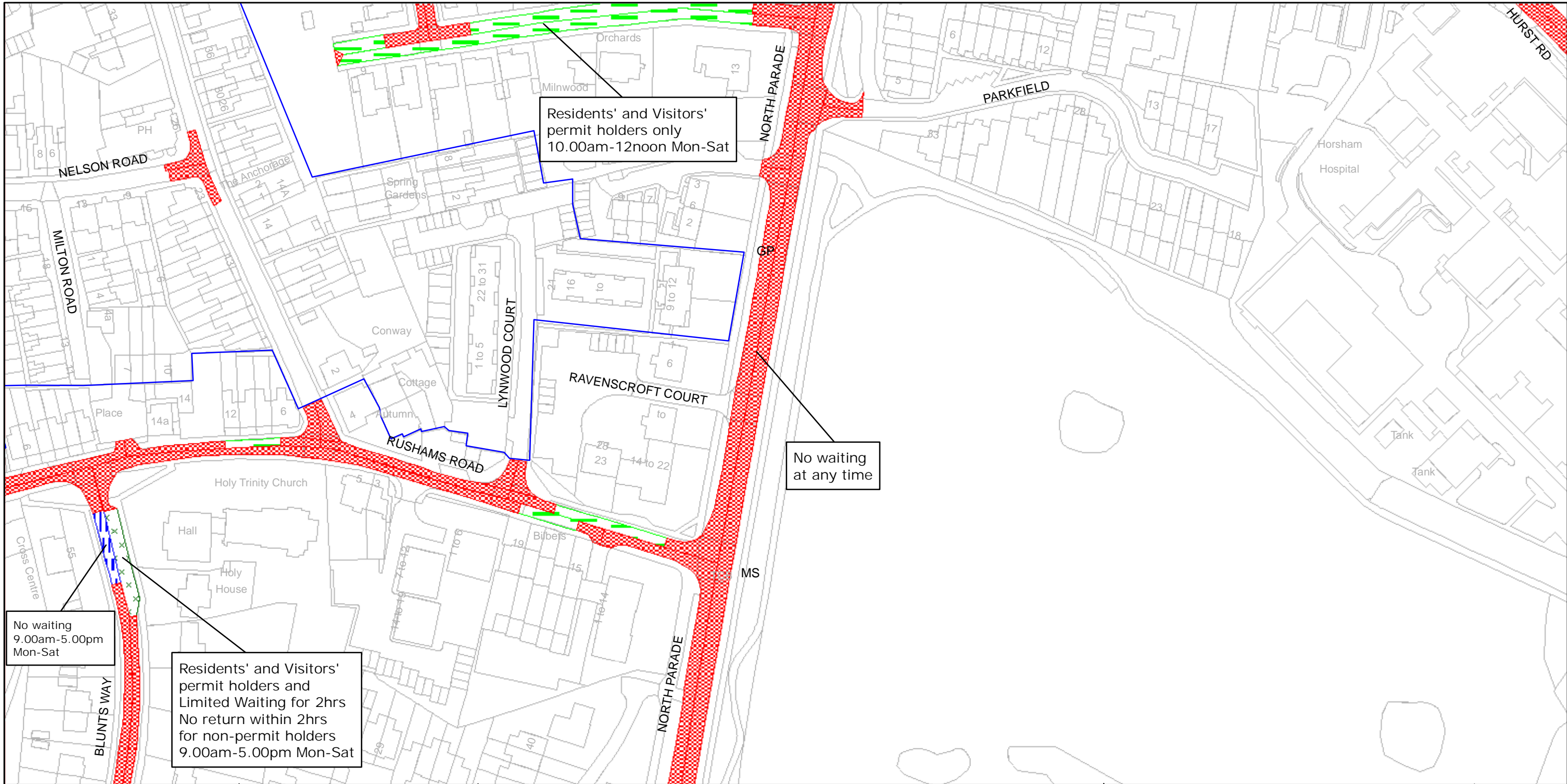

West Sussex County Council
Highways & Transport
The Grange
Tower Street
Chichester
West Sussex
PO19 1RH

HORSHAM DISTRICT: HORSHAM
WAITING RESTRICTIONS

Reproduced from or based upon 2007 Ordnance Survey mapping with permission of the Controller of HMSO (c) Crown Copyright reserved.
Unauthorised reproduction infringes Crown copyright and may lead to prosecution or civil proceedings West Sussex County Council Licence No. 100018485

TILE REF NO:
TQ1731SWN

SHEET NO 4
SHEET ACTIVE FROM - 21/04/2008



SCALE:
1:1250

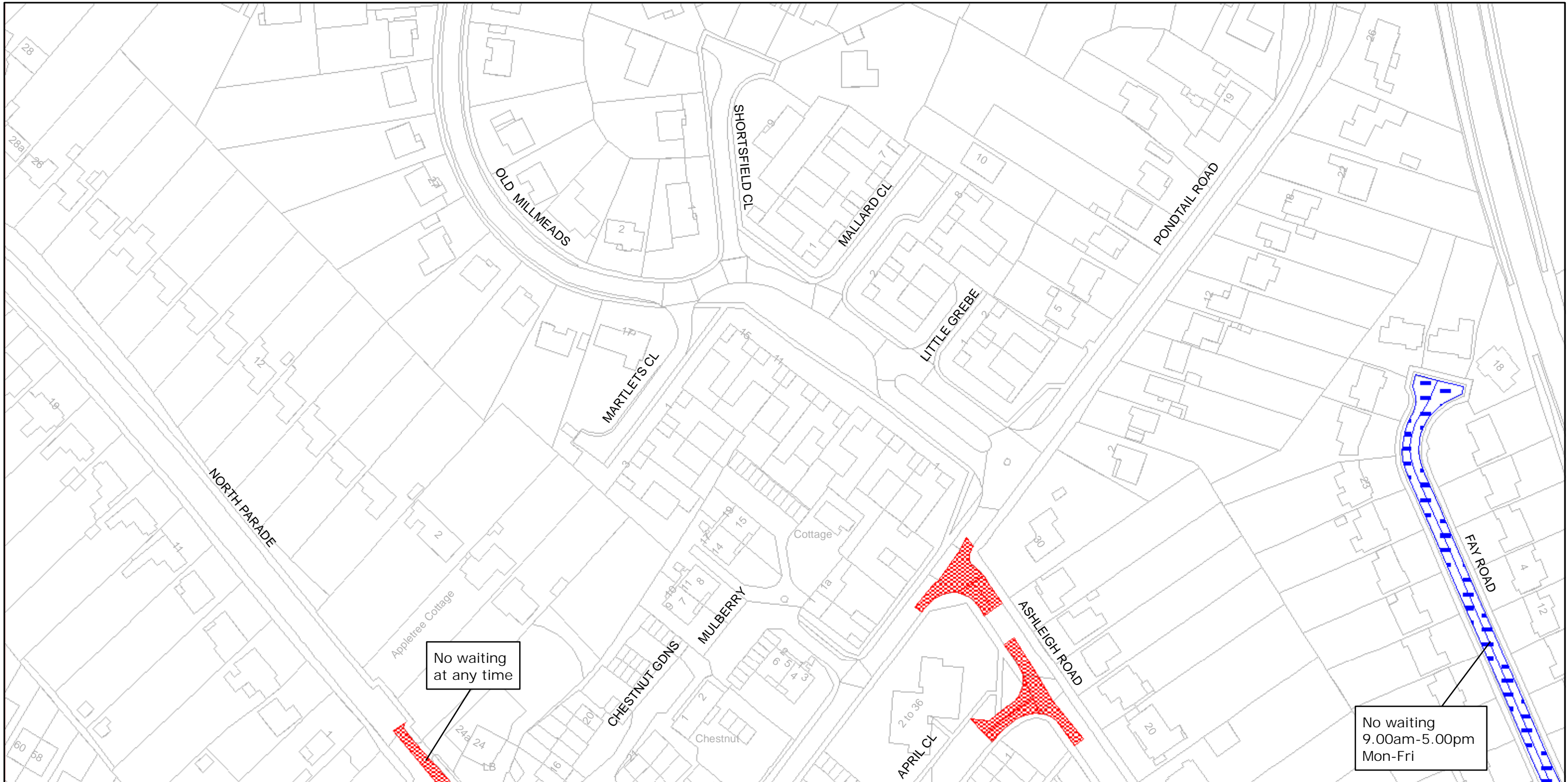

No waiting
at any time

No waiting
9.00am-5.00pm
Mon-Fri



West Sussex County Council
Highways & Transport
The Grange
Tower Street
Chichester
West Sussex
PO19 1RH

Reproduced from or based upon 2007 Ordnance Survey mapping with permission of the Controller of HMSO (c) Crown Copyright reserved.
Unauthorised reproduction infringes Crown copyright and may lead to prosecution or civil proceedings West Sussex County Council Licence No. 100018485

HORSHAM DISTRICT: HORSHAM
WAITING RESTRICTIONS

TILE REF NO:
TQ1732SWS

SHEET NO 3
SHEET ACTIVE FROM - 21/04/2008



SCALE:
1:1250

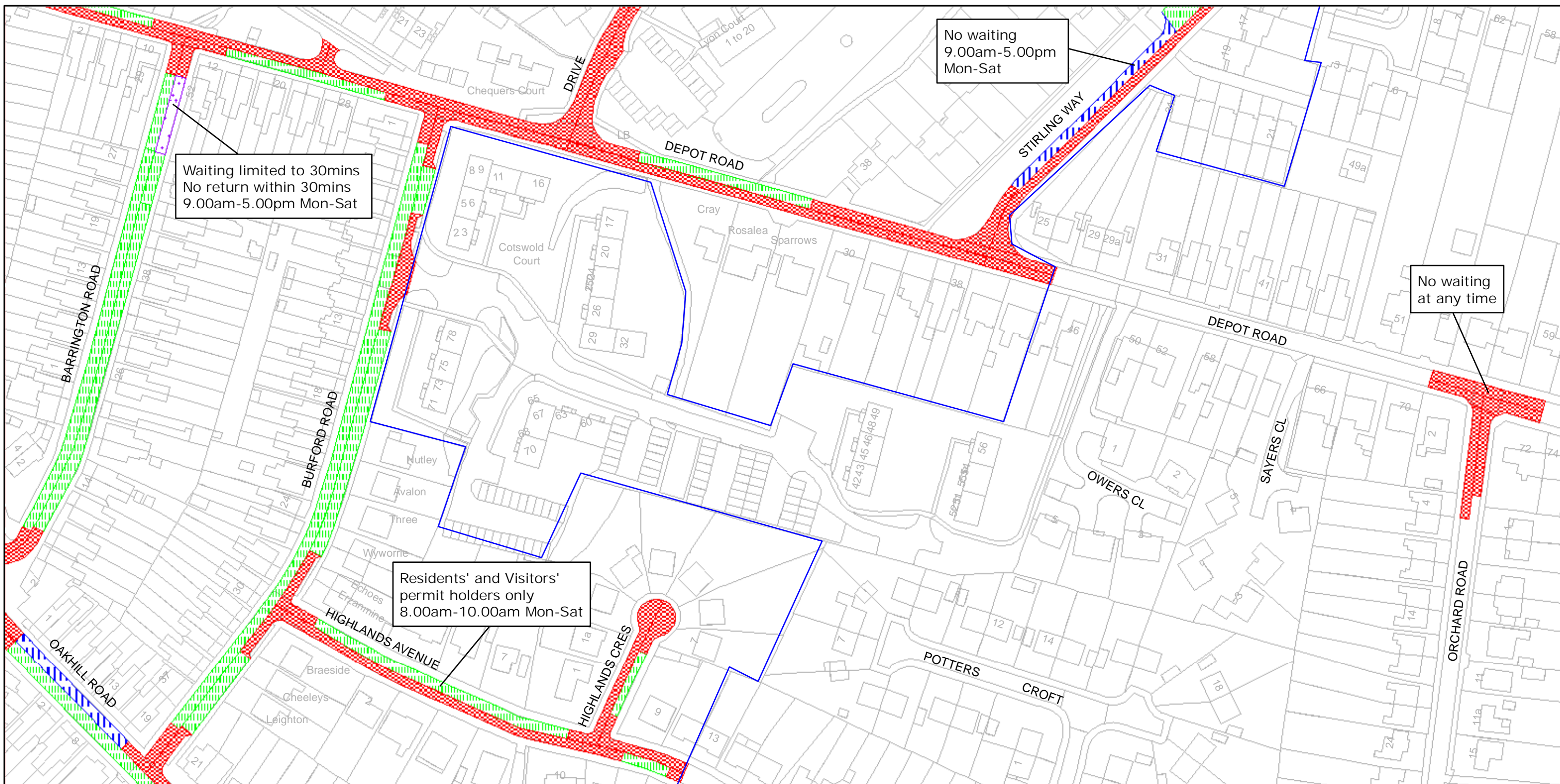

West Sussex County Council
Highways & Transport
The Grange
Tower Street
Chichester
West Sussex
PO19 1RH

HORSHAM DISTRICT: HORSHAM WAITING RESTRICTIONS

Reproduced from or based upon 2007 Ordnance Survey mapping with permission of the Controller of HMSO (c) Crown Copyright reserved.
Unauthorised reproduction infringes Crown copyright and may lead to prosecution or civil proceedings West Sussex County Council Licence No. 100018485

TILE REF NO:
TQ1830NWN

SHEET NO 4
SHEET ACTIVE FROM - 21/04/2008



SCALE:
1:1250